

# FIFTH & WEST RESIDENCES

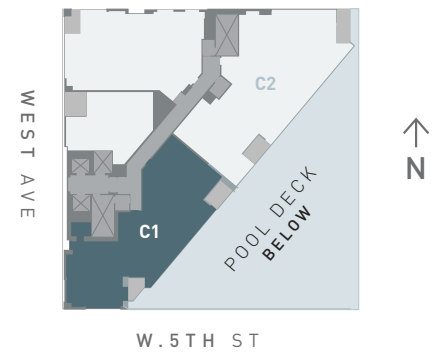

AVAILABLE ON SKY & JR. PENTHOUSE LEVELS  
FLOORS 16-38



## RESIDENCE C1

2,517 SF Interior | 129 SF Terrace | 2,646 SF Total | 3 Bedroom / 3 Bathroom + Study  
VIEWS | West / South / Southeast

5THANDWEST.COM / 512 872 6616  
501 WEST AVENUE / AUSTIN, TX 78701



WE ARE IN COMPLIANCE WITH TITLE VIII OF THE CIVIL RIGHTS ACT OF 1968. WE HAVE NOT, AND WILL NOT, EITHER DIRECTLY OR INDIRECTLY, DISCRIMINATE AGAINST YOU OR ANY OTHER PROSPECTIVE PURCHASER ON THE BASIS OF RACE, COLOR, RELIGION, SEX OR NATIONAL ORIGIN. PRICE AND AVAILABILITY SUBJECT TO CHANGE. © DECEMBER 2015, 5TH AND WEST OWNER, L.P. ALL RIGHTS RESERVED. FLOOR PLANS SHOWN ARE NOT TO ANY PARTICULAR SCALE AND ARE SUBJECT TO CHANGE. ALL DIMENSIONS SHOWN HEREON ARE APPROXIMATE AND MAY VARY FROM THE DESCRIPTION AND DEFINITION OF THE UNIT AS SET FORTH IN THE PURCHASE CONTRACT OR THE CONDOMINIUM DOCUMENTS. PLEASE REVIEW THE CONDOMINIUM DOCUMENTS FOR A DESCRIPTION OF HOW THE UNITS ARE MEASURED, ROOM LAYOUTS AND THE LOCATION OF APPLIANCES ARE SUBJECT TO CHANGE.